

# Heat shrink break out caps



Cables (1.2) kV For indoor and outdoor use: underground, above ground, under water and in cable ducts

## Features

- Hot melt coating inside
- Polyolefine crosslinked
- Fast recovery
- Shrink temperature 70°C till 100°C
- Continuous temperature range from -40°C till +100°C
- Good resistance against UV and chemicals
- Corrosion resistant
- Cadmium free and halogen free
- Colour: black

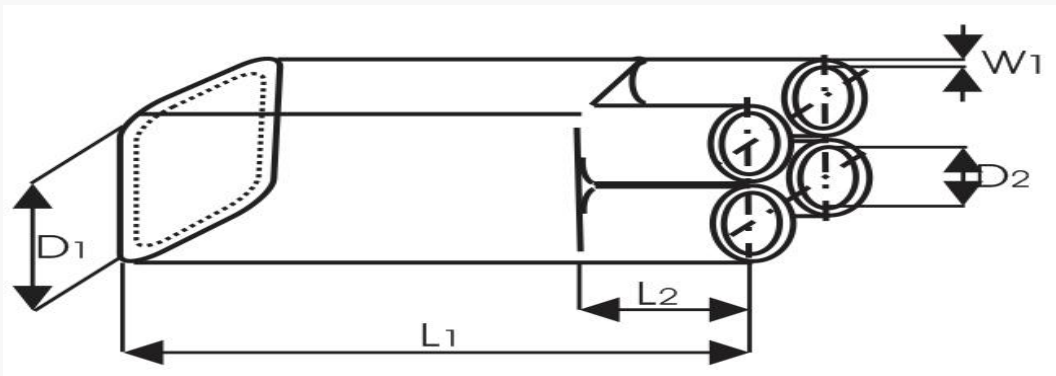

## Specifications

# Heat shrink break out caps

Characteristics	Unit	Value	Standard
Physical characteristics			
Shrink temperature	°C	> 125	
Density	g / cm <sup>3</sup>	> 1.01	DIN 53479 / ISO 1183
Tensile strength	N / mm <sup>2</sup>	12	IEC-540
Elasticity	N / mm <sup>2</sup>	70	IEC-527
Elongation at break	%	300	IEC-540
Hardness	Shore D	42	DIN 53505 / ISO 868
Flexibility at low temperatures			ASTM D 2671
Thermal characteristics			
Altering(168h/150°C)			ISO 188
Continuous temperature limit	°C	-40 till +100	DIN 53 446
Electrical characteristics			
Dielectric strength	kV / mm	> 10	IEC-243
Volume resistivity	Ohm x cm	> 1 x 10 <sub>12</sub>	IEC-93 / ASTM D-257
Chemical characteristics			
Corrosion		geen	ASTM D 2671
Water absorbtion	%	< 0.05	DIN 53 495/1L
Chemical resistance during 24h/23°C in Trafo-oil, Petroleum ISO 1817		Scale 1	ISO 846
Adhesive			
Water absorbtion	%	< 0.15	DIN 53 495
Dielectric strength	kV / mm	> 12	VDE 0303
Adhesion			DIN 30672

## Heat shrink break out caps

to PE	N / cm	> 350	
to PVC	N / cm	> 150	
to PU	N / cm	> 200	
op Zn, Cu and staal	N / cm	> 300	

## Heat shrink break out caps

# Heat shrink break out caps

## Products

Art.nr.	Product Name	Colour	D1 / D1* mm	D2 / D2* mm	L1 / L1* mm	L2 / L2* mm	Order unit
8.800200 UK	Break out cap 2 way, 2 x 1,5 - 25mm <sup>2</sup>	light blue	28/8	12/3	70/85	15/20	1 pcs/bag
8.800210 UK	Break out cap 2 way, 2 x 25 - 120mm <sup>2</sup>	light blue	60/20	24/7	95/120	25/34	3 pcs/bag
8.800215 UK	Break out cap 2 way, 2 x 95 - 185mm <sup>2</sup>	light blue	70/22	30/8	95/120	25/34	3 pcs/bag
8.800301 UK	Break out cap 3 way, 3 x 6-35mm <sup>2</sup>	light blue	37/14	15/4	80/100	15/21	15 pcs/bag
8.800310 UK	Break out cap 3 way, 3 x 35 - 120mm <sup>2</sup>	light blue	60/20	25/8	160/188	45/62	3 pcs/bag
8.800311 UK	Brea -out cap 3 way, 3 x 95 - 150mm <sup>2</sup>	light blue	80/30	36/13	185/215	60/75	2 pcs/bag
8.800330 UK	Break out cap 3 way, 3 x 120 - 300mm <sup>2</sup>	light blue	110/45	55/20	200/235	70/88	2 pcs/bag
8.800400 UK	Break out cap 4-way, 4 x 2.5 - 10mm <sup>2</sup>		40/12	12/3	80/100	15/25	

# Heat shrink break out caps

8.800410 UK	Break out cap 4-way, 4 x 4 - 35mm <sup>2</sup>	light blue	41/16	14/4	80/100	15/23	12 pcs/bag
8.800416 UK	Break out cap 4-way, 4 x 4 - 25.0mm <sup>2</sup>	light blue	50/16	16/4	75/95	15/23	10 pcs/bag
8.800420 UK	Break out cap 4 way, 4 x 16 - 70mm <sup>2</sup>	light blue	58/26	21/7	140/170	32/48	10 pcs/bag
8.800435 UK	Break out cap 4 way, 4 x 25 - 150mm <sup>2</sup>	light blue	70/31	25/9	158/192	32/47	5 pcs/bag
8.800440 UK	Break out cap 4 way, 4 x 95 - 240mm <sup>2</sup>	light blue	90/42	35/13	170/210	40/52	5 pcs/bag
8.800450 UK	Break out cap 4 way, 4 x 150 - 300mm <sup>2</sup>	light blue	125/44	40/14	175/208	40/51	2 pcs/bag
8.800510 UK	Break- out cap 5-way, 5 x 10-35mm <sup>2</sup>	light blue	50/16	12/4	85/110	22/33	5 pcs/bag
8.800520 UK	Break- out cap 5-way, 5 x 25-70mm <sup>2</sup>	light blue	57/17	15/4	75/110	23/33	
8.800640 UK	Break out cap 6 way, 6 x 16 - 95mm <sup>2</sup>	light blue	85/37	23/7	110/130	30/46	2 pcs/bag

## Heat shrink break out caps

8.800742 UK	Break out cap 7 way, 7 x 16 - 95mm <sup>2</sup>	light blue	95/37	23/7	110/130	30/46	2 pcs/bag
----------------	---	------------	-------	------	---------	-------	-----------